

ANGUS COUNCIL

ROADS COMMITTEE

24 APRIL 1997

JUNCTION IMPROVEMENT**MYRE ROAD/CRAIG O' LOCH ROAD JUNCTION, FORFAR**

REPORT BY THE DIRECTOR OF ROADS

ABSTRACT

This report informs the Committee of changes to the extent of the junction improvement at Myre Road/Craig O' Loch Road Junction, Forfar.

1 RECOMMENDATION

It is recommended that the Committee agree to note the amendments to the extent of the junction improvement at Myre Road/Craig O' Loch Road Junction, Forfar as detailed in the Report.

2 INTRODUCTION

The Roads Committee of 17 October 1996 approved Report No 851/96 which included

- a) the Myre Road/Craig O' Loch Road junction improvement.
- b) the provision of a footway on the south side of Myre Road between Myre Road Car Park and Craig O' Loch Road and
- c) the provision of a footway on the north side of Myre Road between Myre (East) Car Park and Castle Street.

3 DETAILS

- (i) As a result of subsequent detailed design and Statutory Undertakers consultation the estimate for the work as approved was 20% higher than allowed for in the Road Safety/Traffic Calming Capital budget for 1996/97.

The bulk of this cost was in the provision of the footway on the south side of Myre Road and the re-location of a gas main which would have been under the heel kerb and re-aligned boundary fence at the rear of the new footway. (See Appendix 1 - Approved Drg No T96 - 150).

Since there is already a footway on the north side of Myre Road between Myre Road Car Park and Craig O' Loch Road the provision of a footway on the south side, although beneficial, could be regarded as a low priority with regard to the rest of the improvements. Accordingly and to have the work carried out within the 1996/97 financial year the Director of Roads approved the deletion of the footway apart from the section at the widened part of Myre Road at its junction with Craig O' Loch Road. (See Appendix 2 - Amended Drg No Myre/02). In addition, in the interests of pedestrian safety at the junction, the Director of Roads approved the provision of two pedestrian islands on Craig O' Loch Road.

- (ii) The Traffic Order for a one-way westwards along Myre Road between Castle Street and Myre (East) Car Park has not yet been finalised and consultations are still taking place. Accordingly the provision of a footway between those locations has been postponed until the Order is approved and will be constructed in the 1997/98 financial year.

4 FINANCIAL IMPLICATIONS

The savings will bring the estimated cost to the budget figure for the 1996/97 financial year. The provision of a footway (£6k) between Castle Street and Myre (East) Car Park can be accommodated from the Department's 1997/98 capital allocation for Road Safety.

5 CONSULTATION

The Chief Executive, the Director of Law and Administration and the Director of Finance have been consulted in the preparation of this Report.

Dr Bob McLellan
DIRECTOR OF ROADS

NOTE

No background papers as defined by Section 50D of the Local Government (Scotland) Act 1973 (other than any containing confidential or exempt information) were relied on to any material extent in preparing the above Report.

REPORTS/myre road
15 April, 1997
AWM/PK

Enc

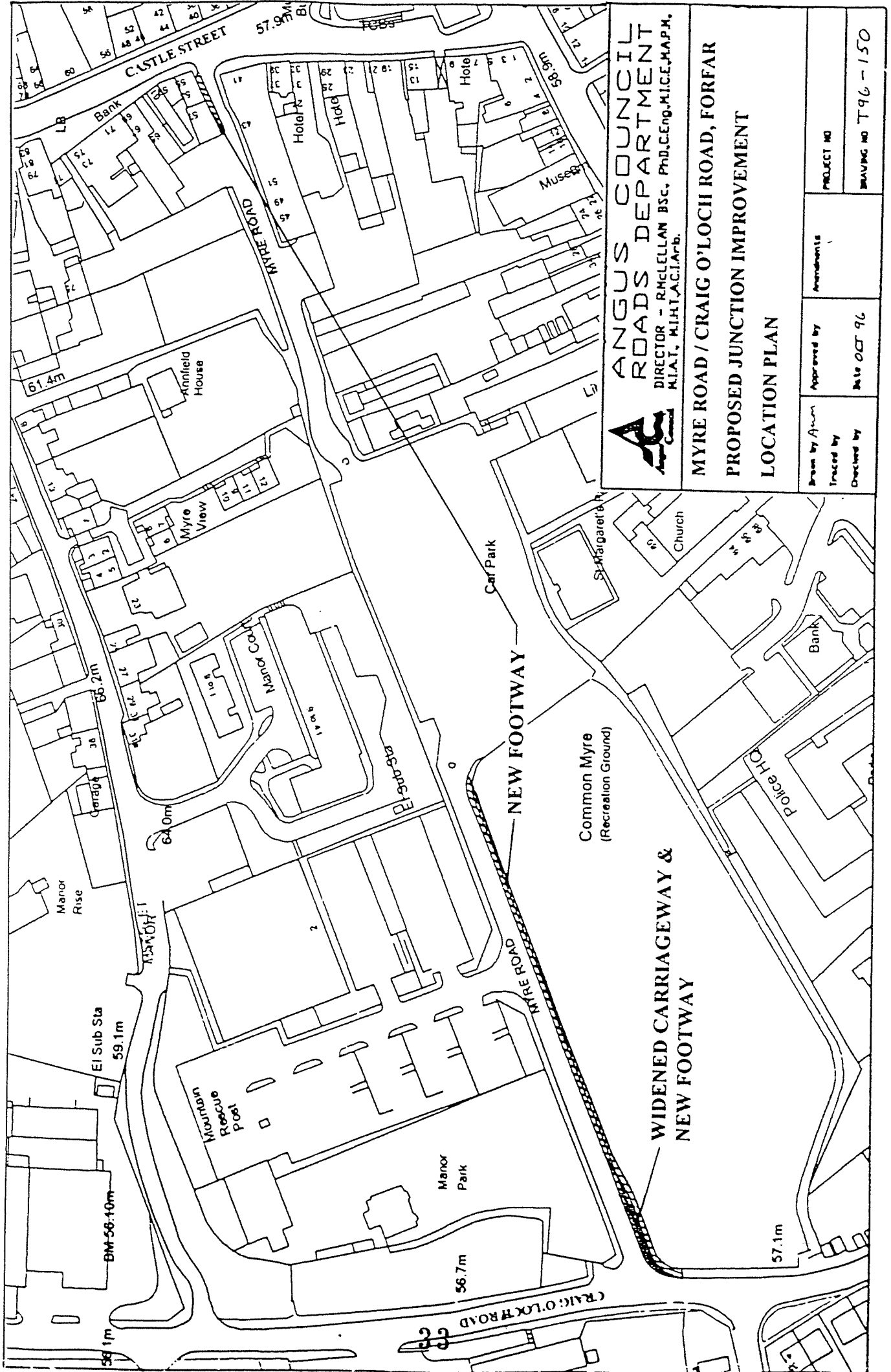

ANGUS COUNCIL
ROADS DEPARTMENT
 DIRECTOR - R.MELLELLAN B.Sc., Ph.D., C.Eng., M.I.C.E., M.A.P.M.,
 M.I.A.T., M.I.H.T., A.C.I.Arb.

<p>MYRE ROAD / CRAIG O'LOCH ROAD, FORFAR PROPOSED JUNCTION IMPROVEMENT LOCATION PLAN</p>		<p>Drawn by Ann Traced by Checked by</p>	<p>Approved by Date OCT 96</p>	<p>PROJECT NO DRAWING NO T96-150</p>
---	--	--	---	---

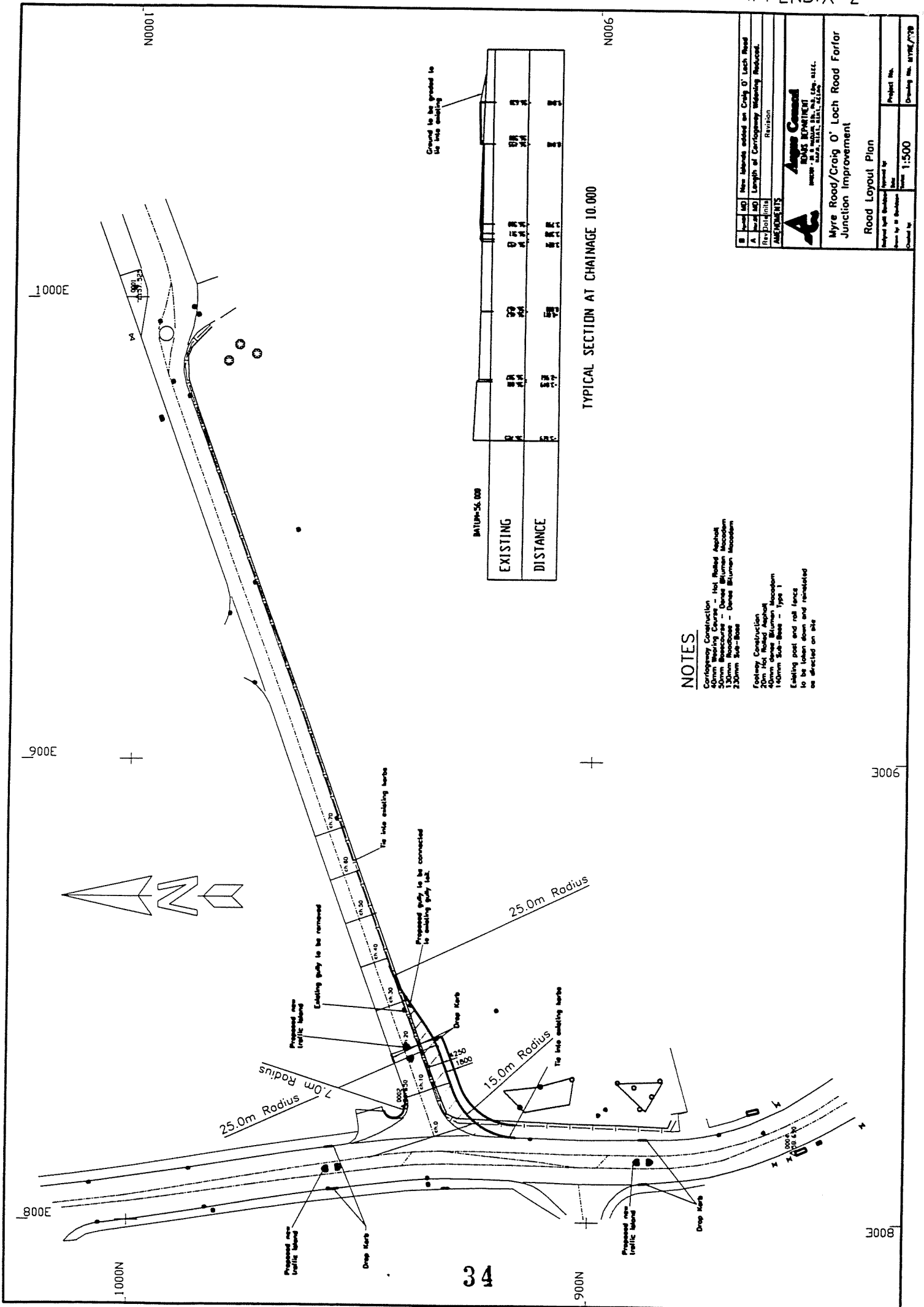

TYPICAL SECTION AT CHAINAGE 10.000

SECTION		DATE		BY	
EXISTING	2.00	2.00	2.00	2.00	2.00
DISTANCE	5.00	5.00	5.00	5.00	5.00

NOTES

- Carriageway Construction - Hot Rolled Asphalt
- 40mm Wearing Course - Dense Bitumen Macadam
- 130mm Basecourse - Dense Bitumen Macadam
- 230mm Sub-Base
- Footway Construction - 20m Hot Rolled Asphalt
- 140mm Dense Bitumen Macadam
- 140mm Sub-Base - Type 1
- Existing post and rail fence to be taken down and reinstated as directed on site

NO	DATE	DESCRIPTION
1	10/01/10	Issue for Approval
2	10/01/10	Issue for Construction

AMEX CONSULTANTS
 ENGINEERING DEPARTMENT
 10/01/10
 Myre Road/Craig O' Loch Road Forfar Junction Improvement
 Road Layout Plan
 Project No. 10/01/10
 Drawing No. 10/01/10